

M6 Adjustable Anchor Bolt

N/S

Direct Fixing Clip
with Anchor (A239)

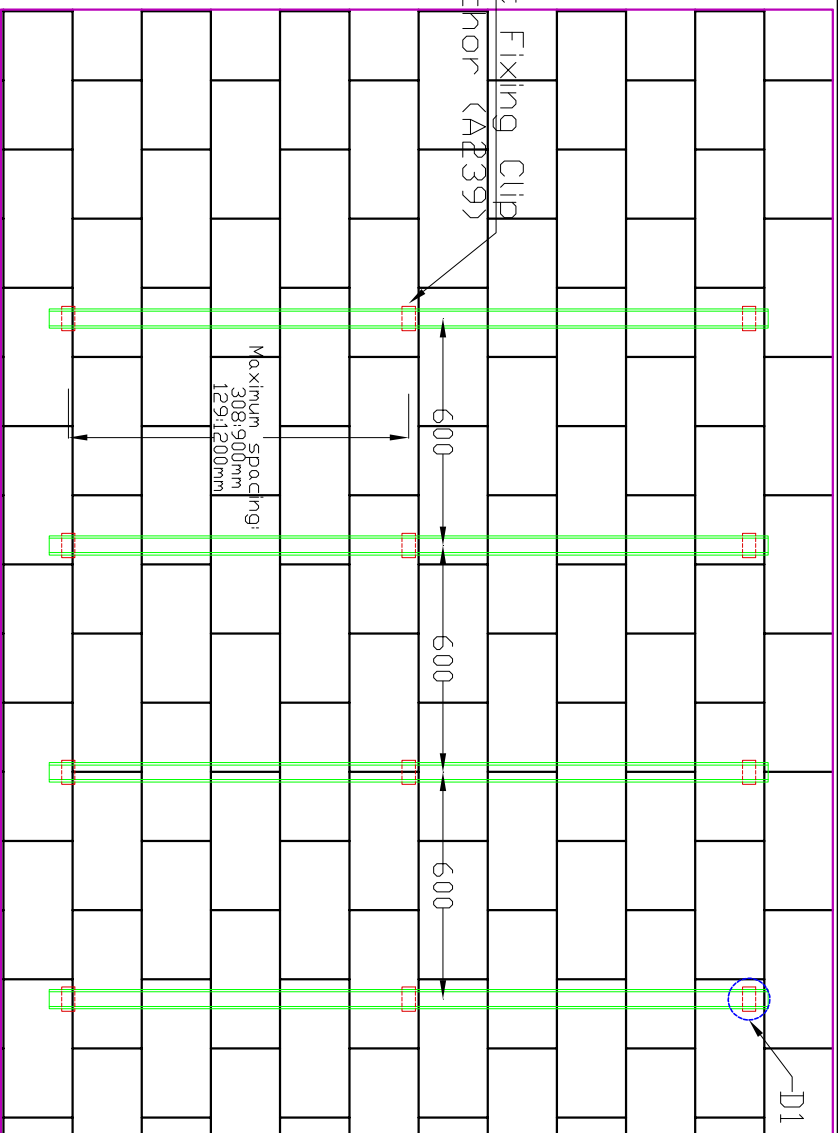

Detail of typical application on masonry wall

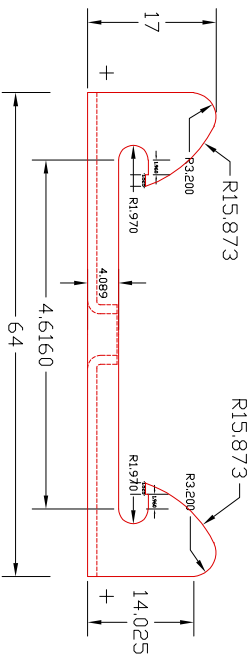

SRP 17mm x 64mm Direct Fixing Clip 239A to Masonry/Concrete

NOTES:

- 1- All dimensions in mm.
- 2- Manufacturing tolerance ± 0.25 mm.
- 3- Manufactured from steel meeting requirements of AS1397 G250-275 or greater.
- 4- Design Capacity - See SRP ceiling tables & current SRP PSI.
- 5- Storage and installation in accordance with SRP specification and design documentation.